

TAV. A 11 - b
 STRUTTURE D'ARREDO
 Abaco delle tipologie
 Panche, prospetti e sezioni

DATA: 25/05/10
 SCALA: 1/10 - 1/5
 PROGETTISTI:
 arch. Pierluigi AMERIO
 Ing. Fabio AQUILANO
 IL RESPONSABILE DEL PROGETTO:
 Ing. Claudio LAMBERTI
 arch. Fernando CARRANI
 IL PROGETTISTA COORDINATORE:
 dott. Paolo MIGLIETTA
 p.s. Giovanni BISSOLO

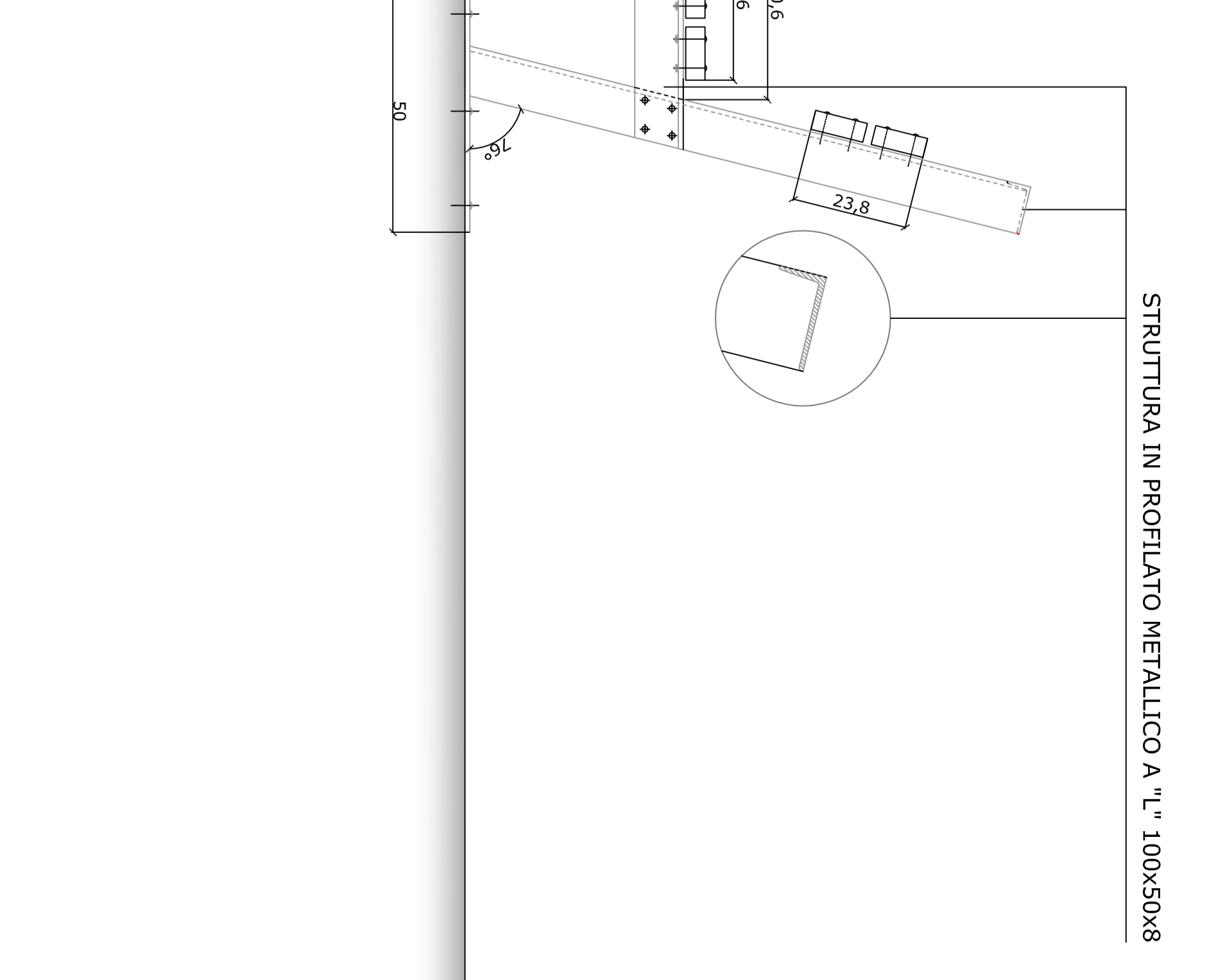
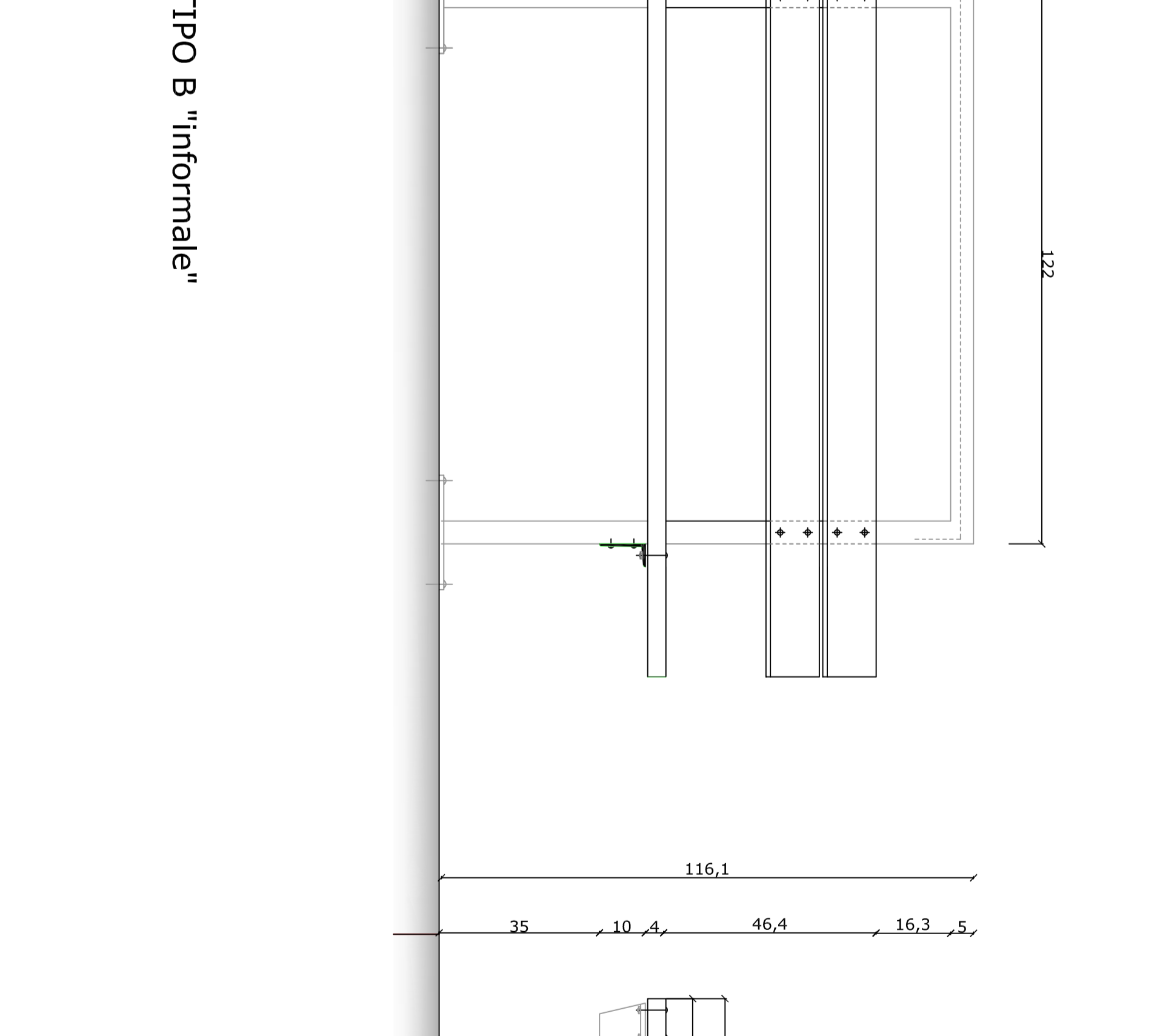
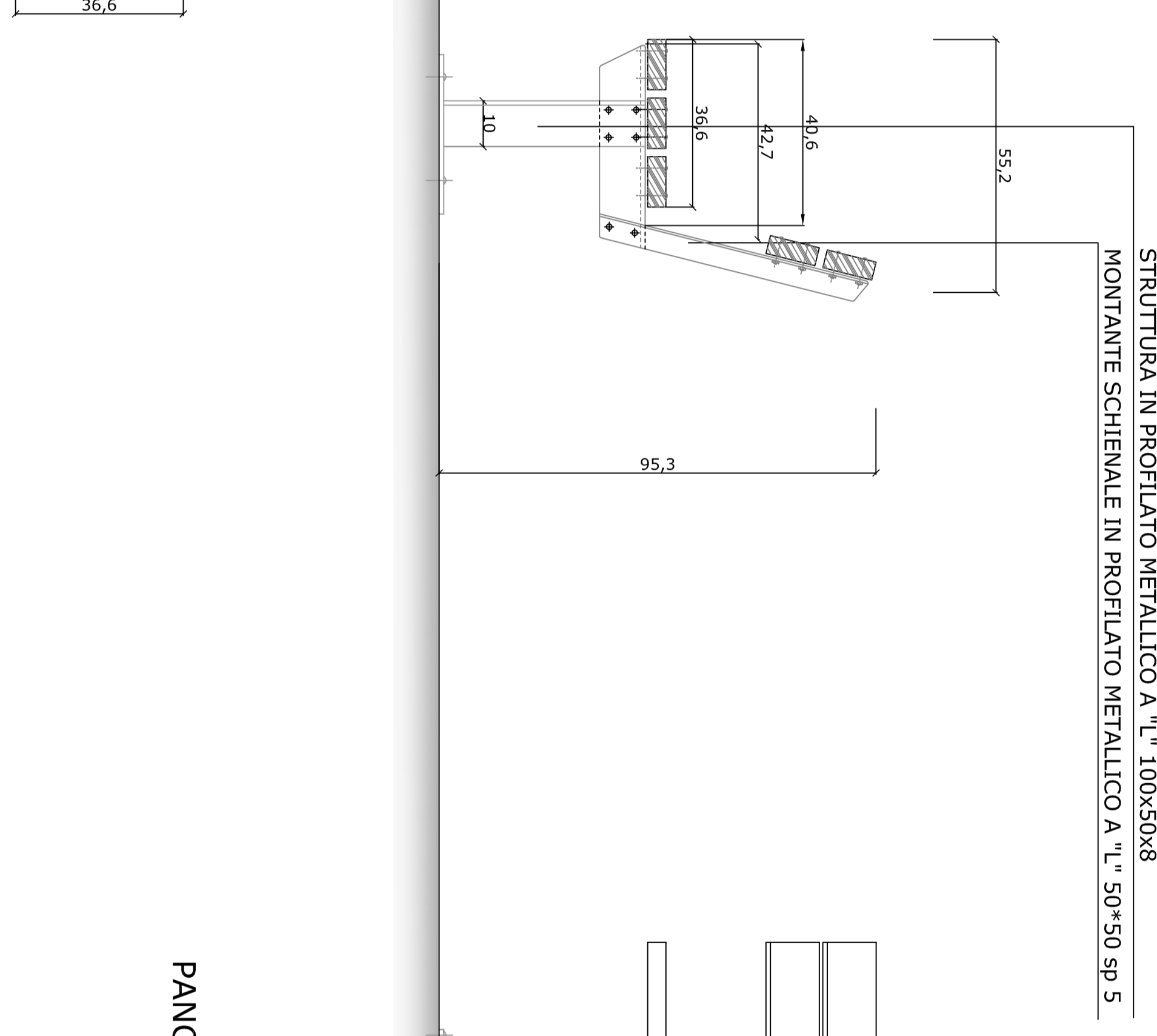
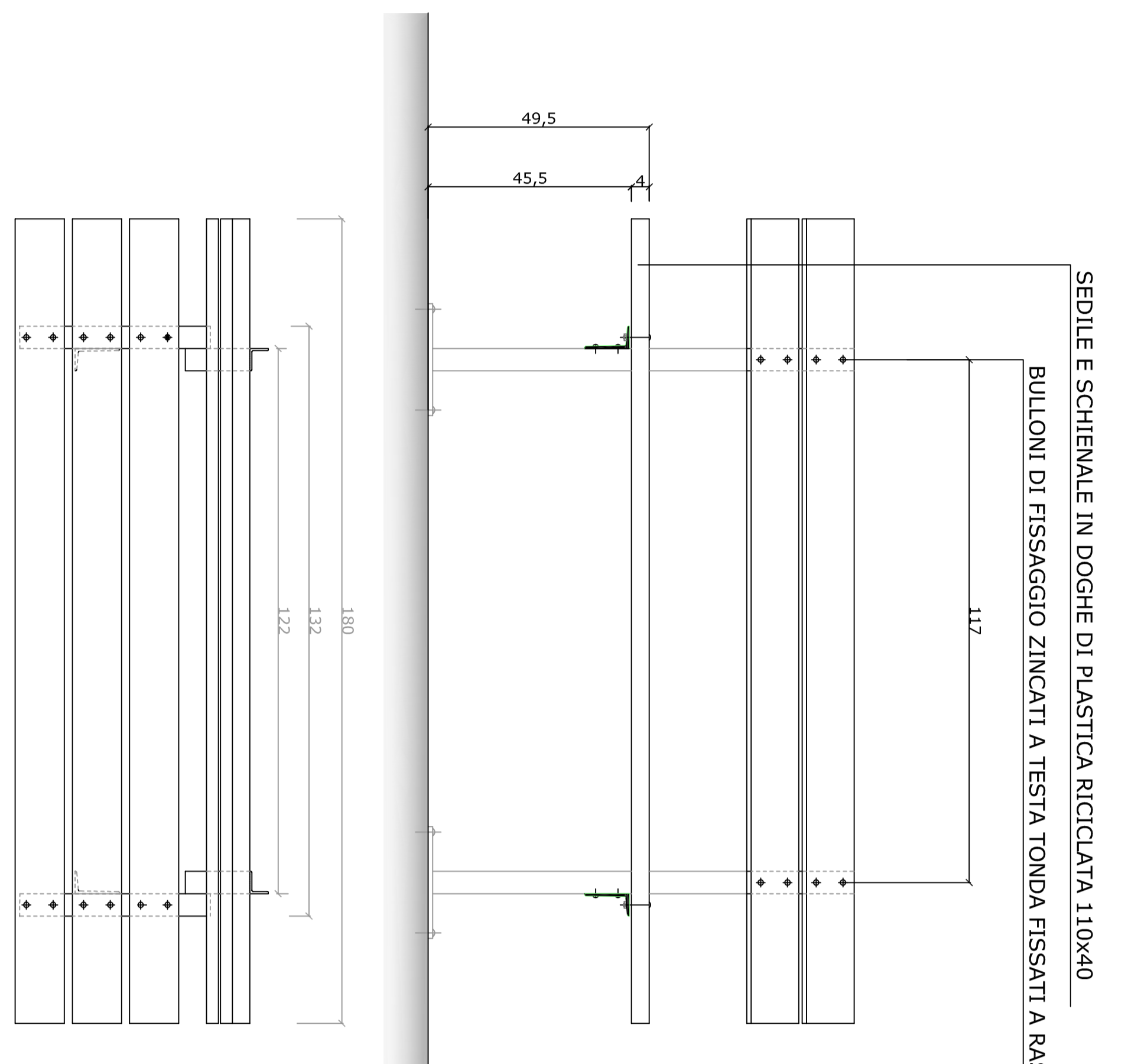

PANCA TIPO A - Modello base

PANCA TIPO B "informale"

Scala 1:10

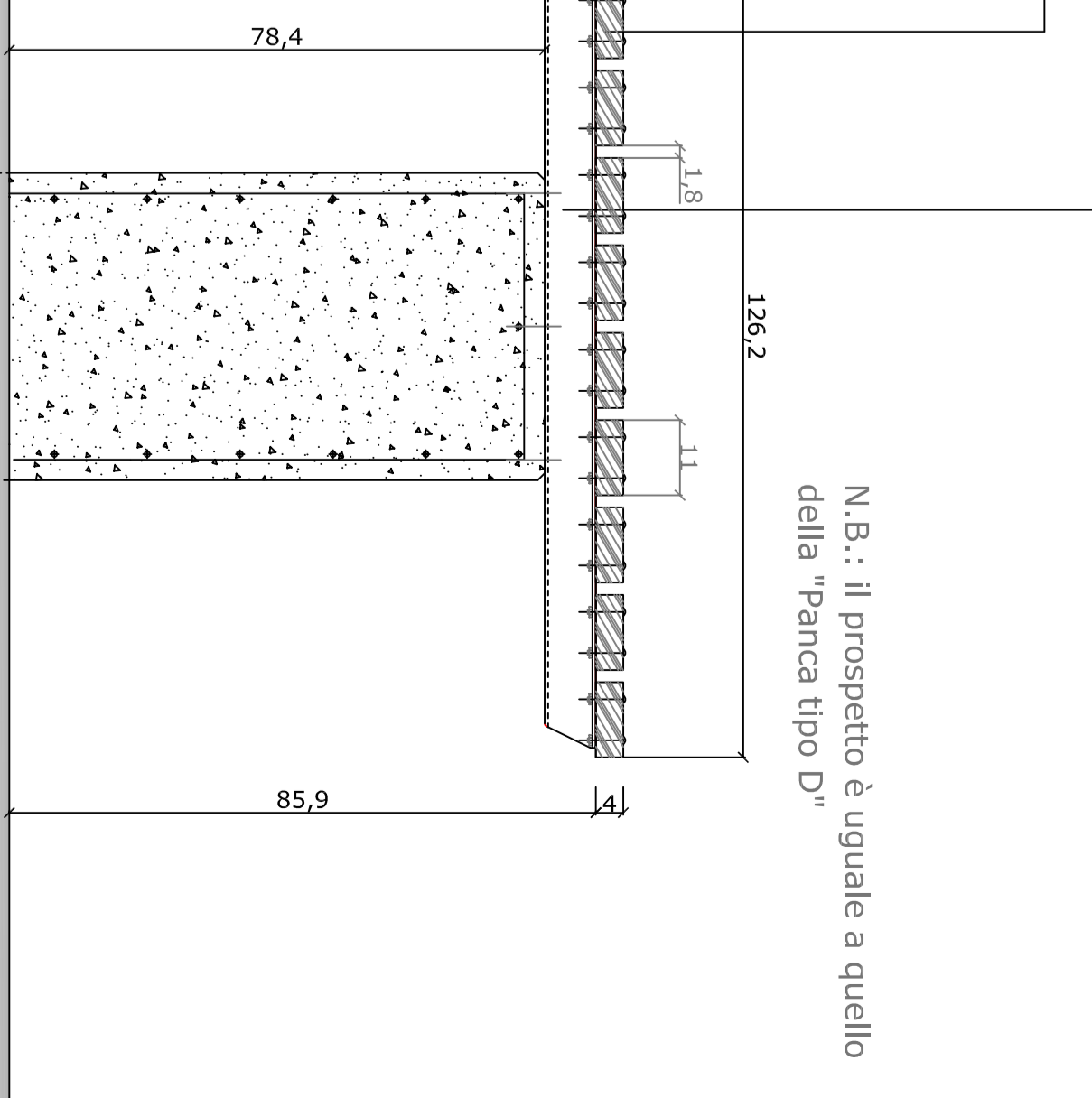
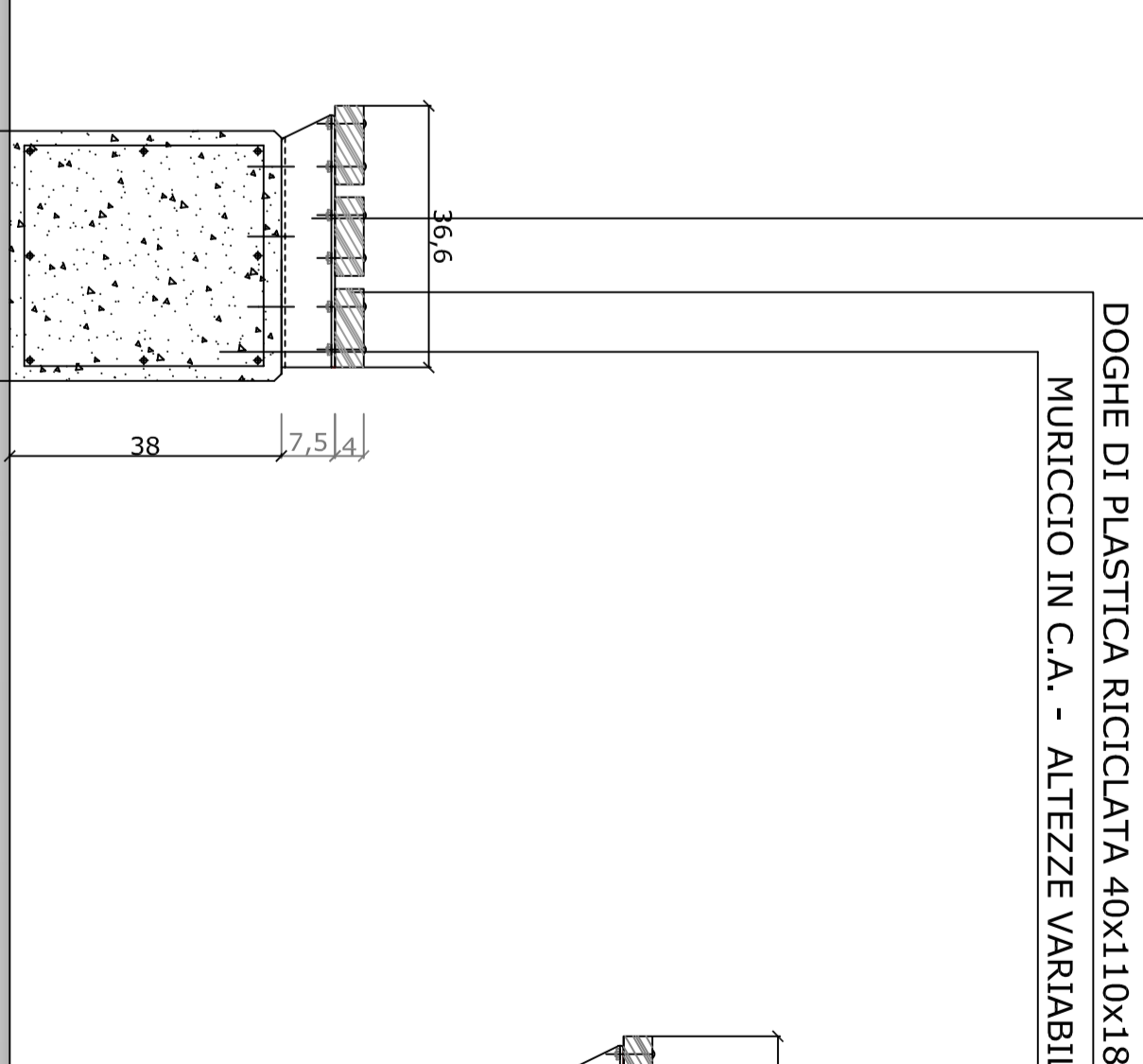
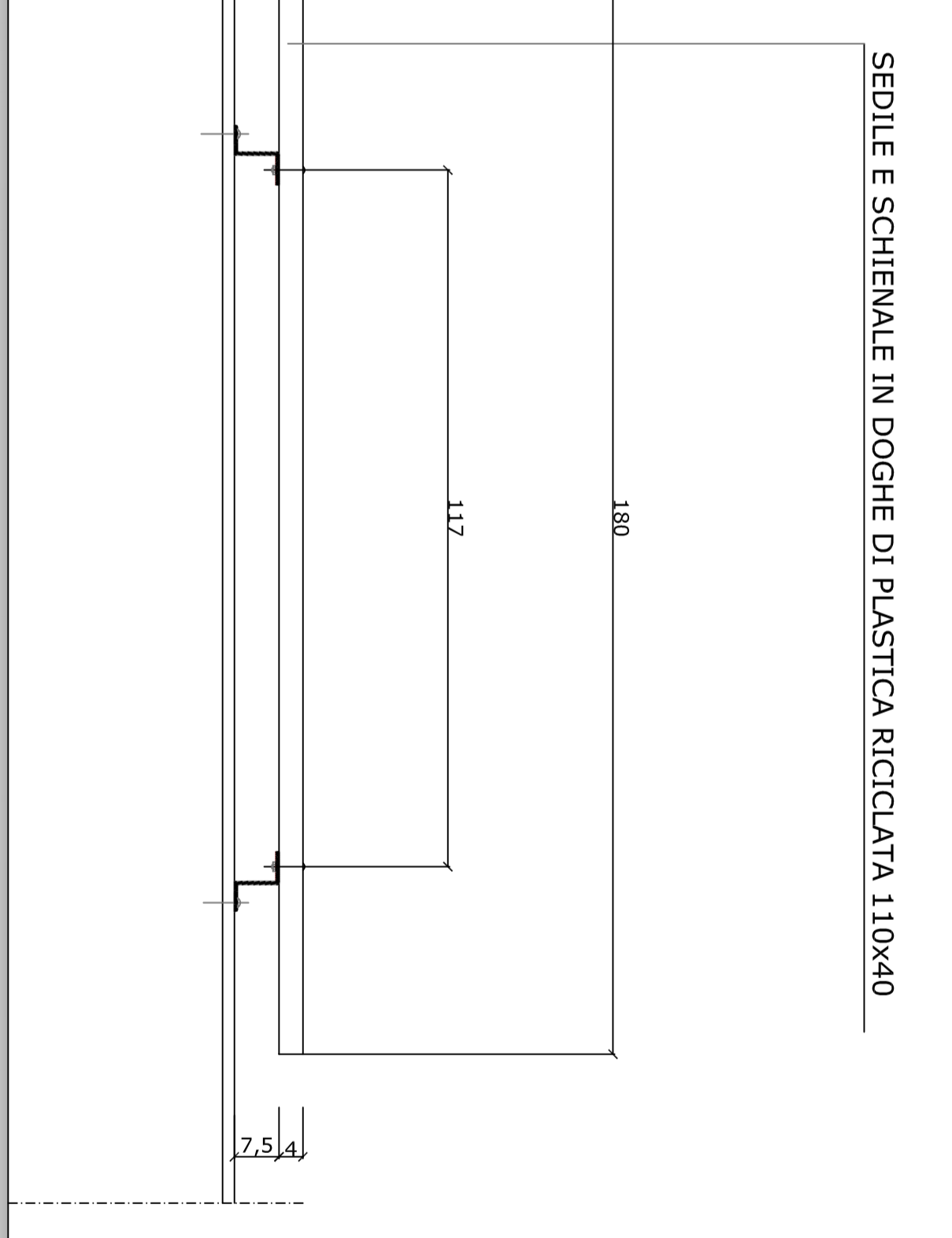
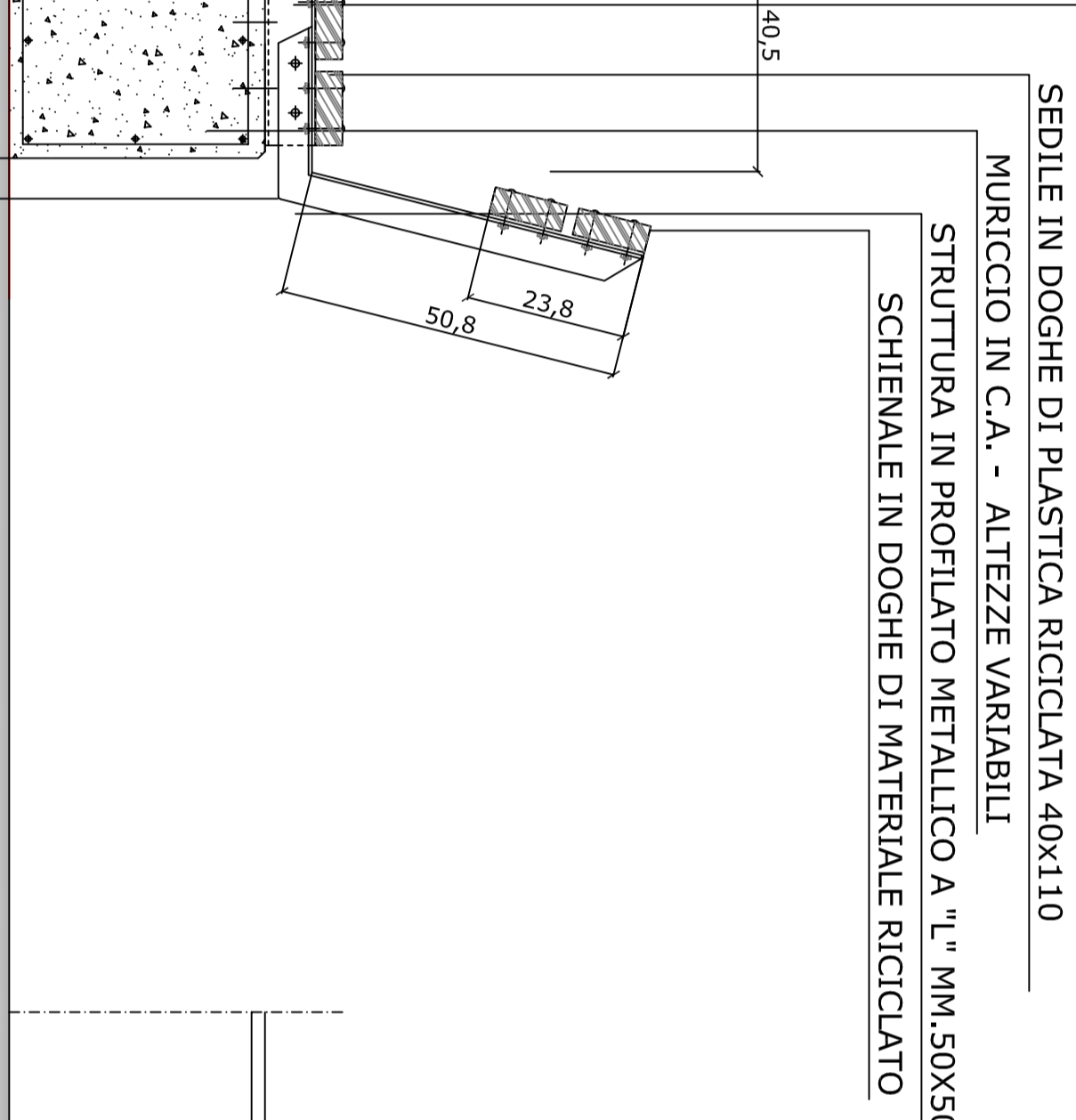
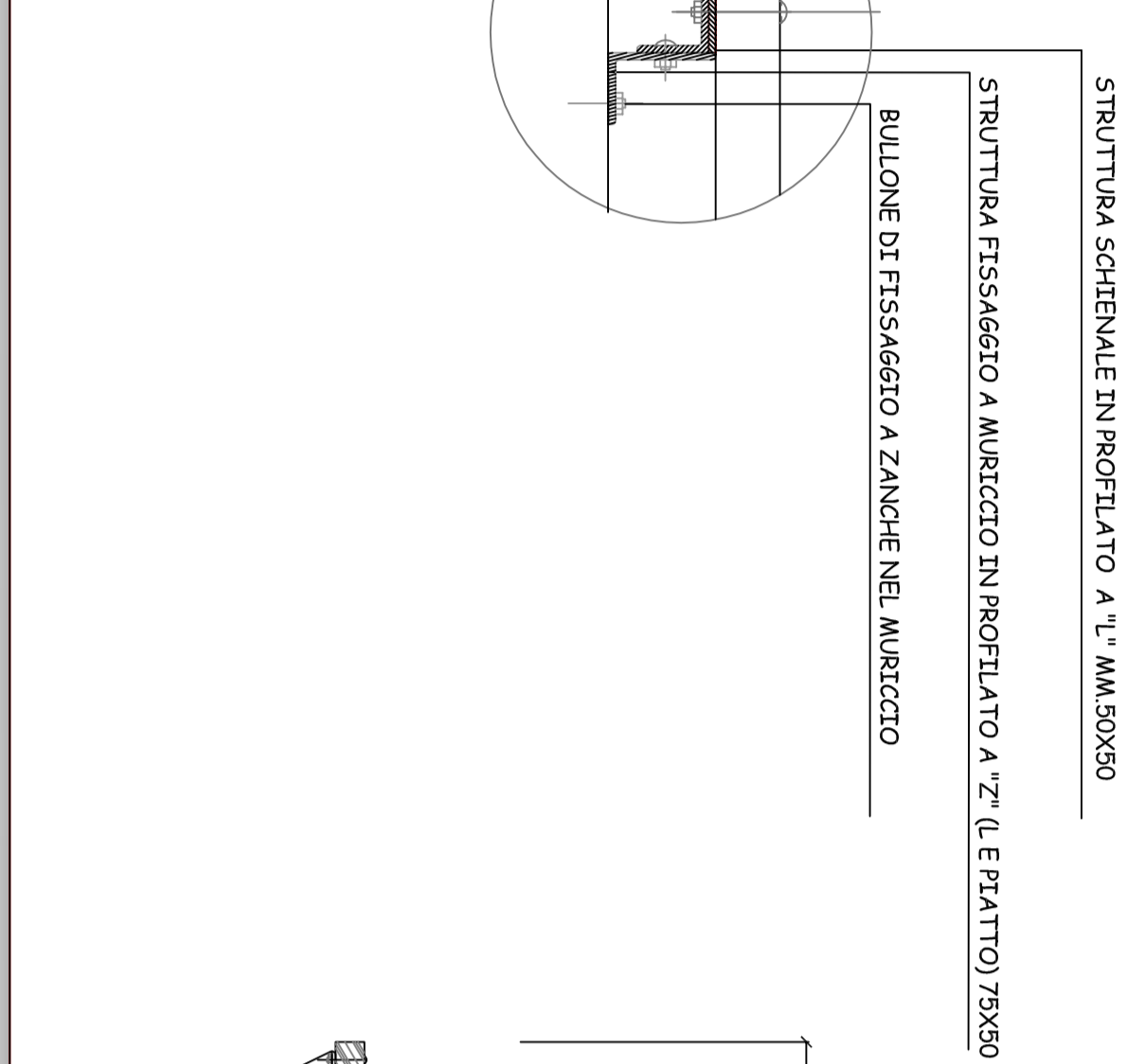
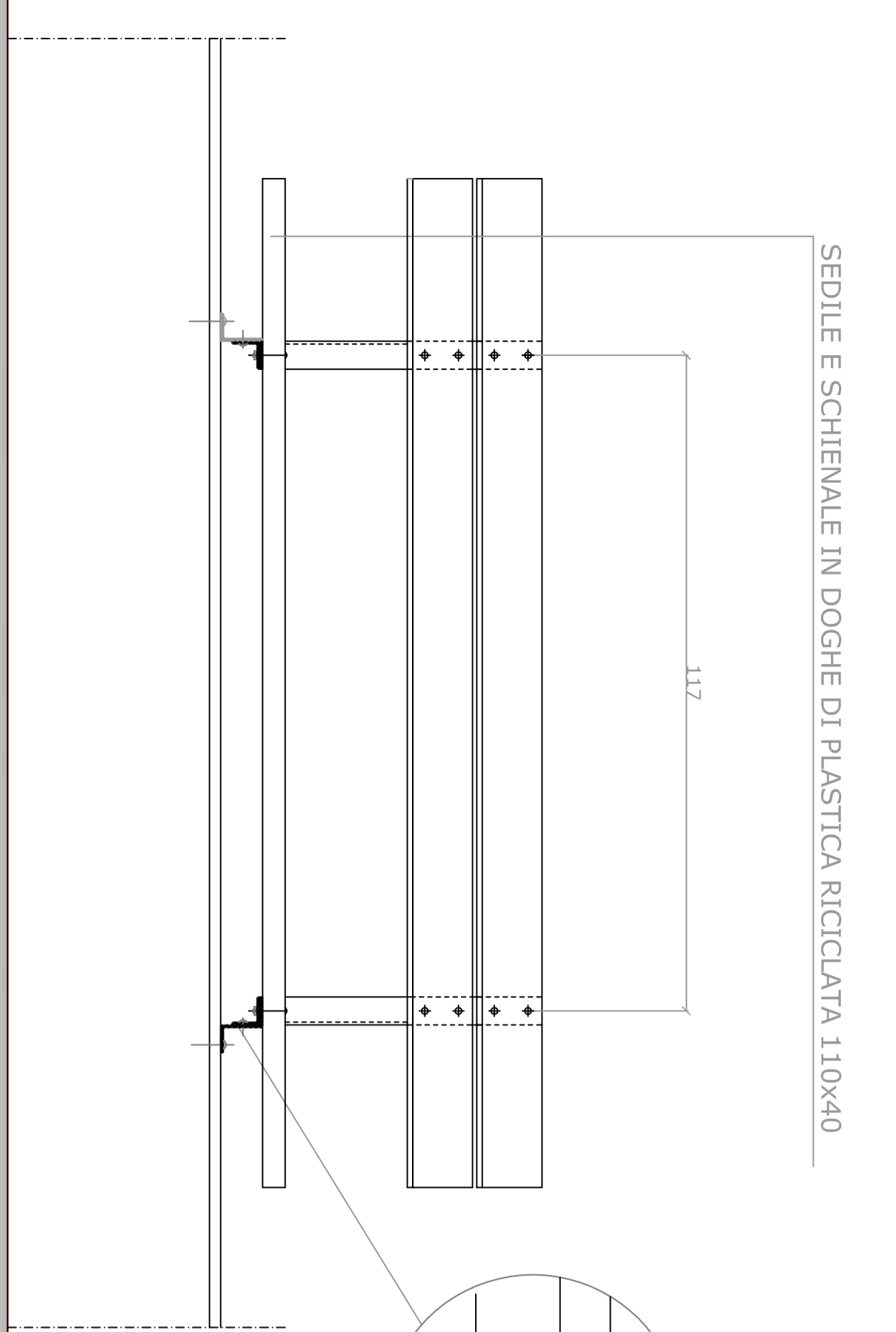

N.B.: Il prospetto è uguale a quello della "panca tipo D"

PANCA TIPO C "su muriccio con schienale"

PANCA TIPO D "su muriccio senza schienale"

STRUTTURA TIPO E "tavolo"

SEDILE E SCHIENALE IN DOGHE DI PLASTICA RICICLATA 110x40

BULLONI ZINCATI TESTA TONDA A RASO

MONTANTE SCHIENALE IN PROFILATO METALLICO A 'L' 50*50 SP 5

STRUTTURA IN PROFILATO METALLICO A 'L' 100x50x8

SPIGOLI STRUTTURA ARROTONDATI A MOLLA R 0,5

PIASTRA ZANCATI DI COLLEGAMENTO PAVIMENTAZIONE 35X35 SP 6

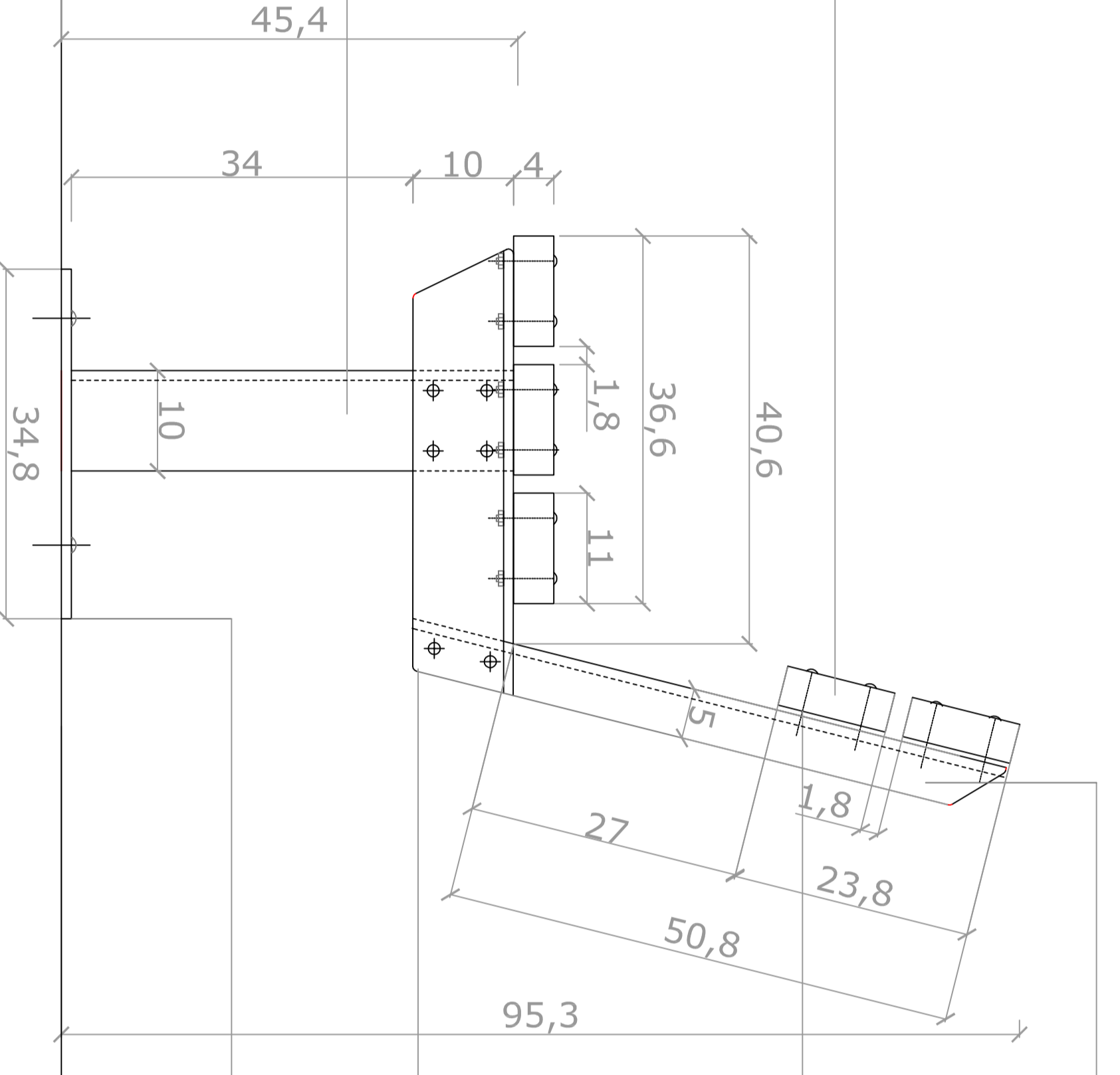

PANCA TIPO A - Modello base - VISTA - Dettaglio Scala 1:5